

SANUS®

**BLACK
SERIES**

BLACK SERIES

The SANUS Black Series is an exclusive line of TV Mounts available by invite only to authorized dealers. All SANUS Black TV Mounts have been designed and engineered based on input direct from Custom Installers. These mounts are easier to use, easier to install and most importantly, easier to sell. No more price shopping or deal hunting from clients because these mounts are only available to authorized dealers.

Easily access cables and wires behind TV while it's still mounted



Upgraded post-install adjustments for even greater flexibility

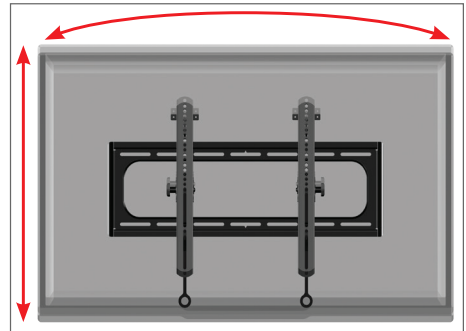

Most products can be placed on any wall with any stud spacing.

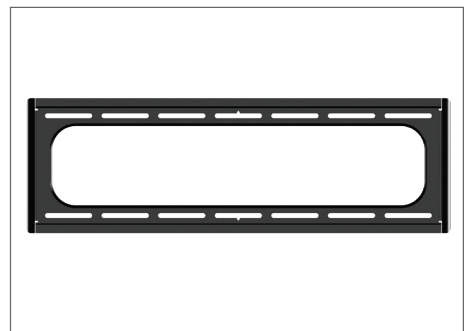

Universal hardware package ensures compatibility

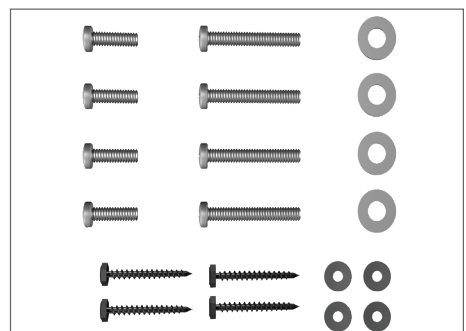

Most products offer ability to add a padlock for security.*



*Excludes CILF130 & CILF124

SANUS®

BLACK SERIES

Compatible with the SA809 large recessed wall box that holds up to six components.

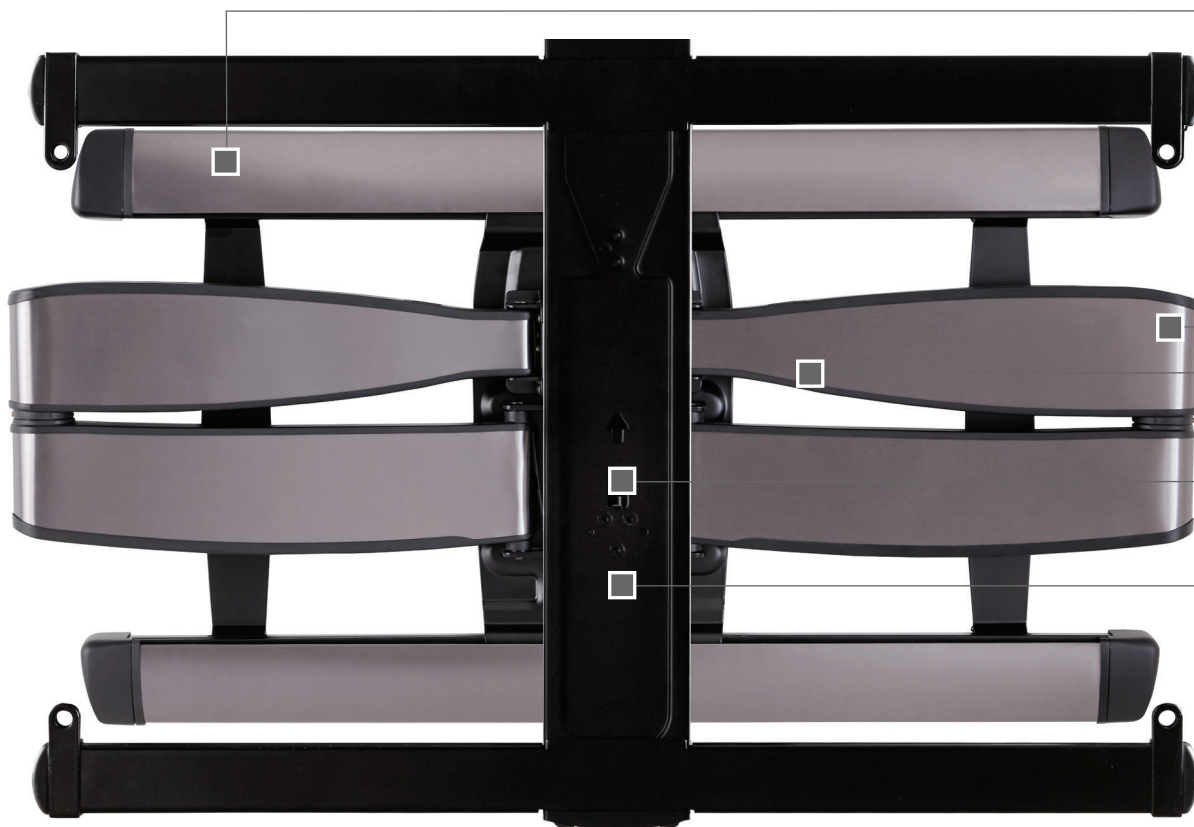

MODEL

CILF230-G1

UPC

793795533913

MSRP

\$409.99

LIST PRICE

\$499.99

MOUNTING PATTERNS - VESA

Min: 200 x 200 | Max: 600 x 400

WEIGHT CAPACITY

175 lbs

DEPTH

2.46"

SUGGESTED TV SIZE RANGE

46"-95"

EXTENDS / TILTS

Extension: 30"; Tilt: +5°/-15°

PRODUCT DIMENSIONS

(w x d x h)
36.73" x 2.46"-30" x 22.03"

PACKAGE DIMENSIONS

(w x d x h)
39.96" x 23.43" x 4.8"

PACKAGE WEIGHT

44.1 lbs

MASTER PACK QUANTITY

1

MASTER PACKAGE

DIMENSIONS (w x d x h)
40.75" x 24.02" x 5.71"

**MASTER PACKAGE
WEIGHT**

44.1 lbs

**COMPATIBLE WITH
UP TO 1 CIASP1**

CILF230 – LARGE FULL MOTION MOUNT



Stylish brushed metal exterior blends seamlessly with TVs and décor.



FluidMotion™ provides unparalleled smoothness and effortless TV movement.



Beneath the metal exterior is an ultra-strong, solid steel frame that provides maximum support.

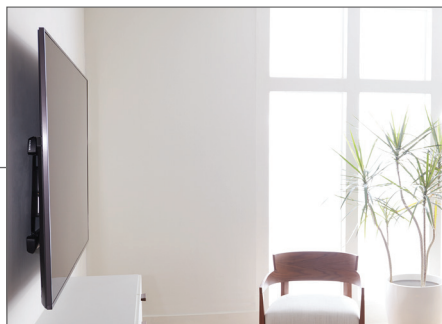

Slim profile holds TV close to the wall for a sleek look.



Steady Set™ ensures TV screen stays in place – eliminating drift and unwanted TV movement.

SANUS®

BLACK SERIES

CILF230 – LARGE FULL MOTION MOUNT

TV INTERFACE - VESA

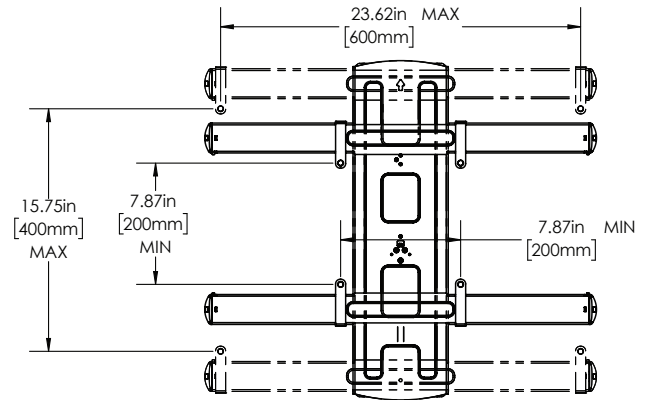

SIDE VIEW

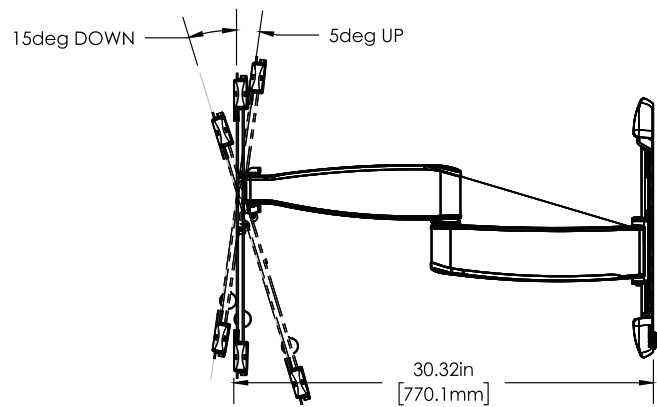

TOP VIEW - EXTENDED

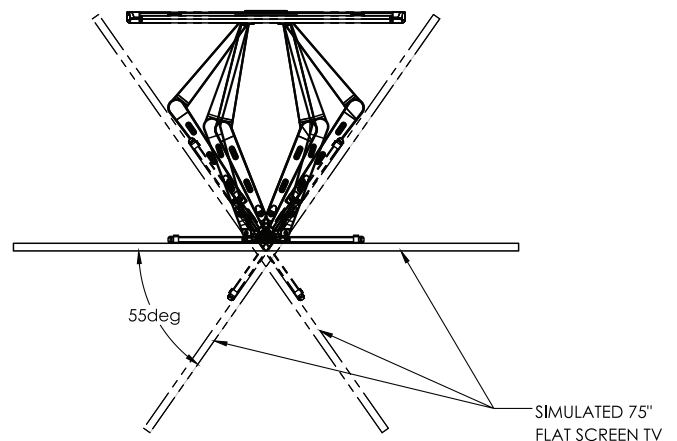

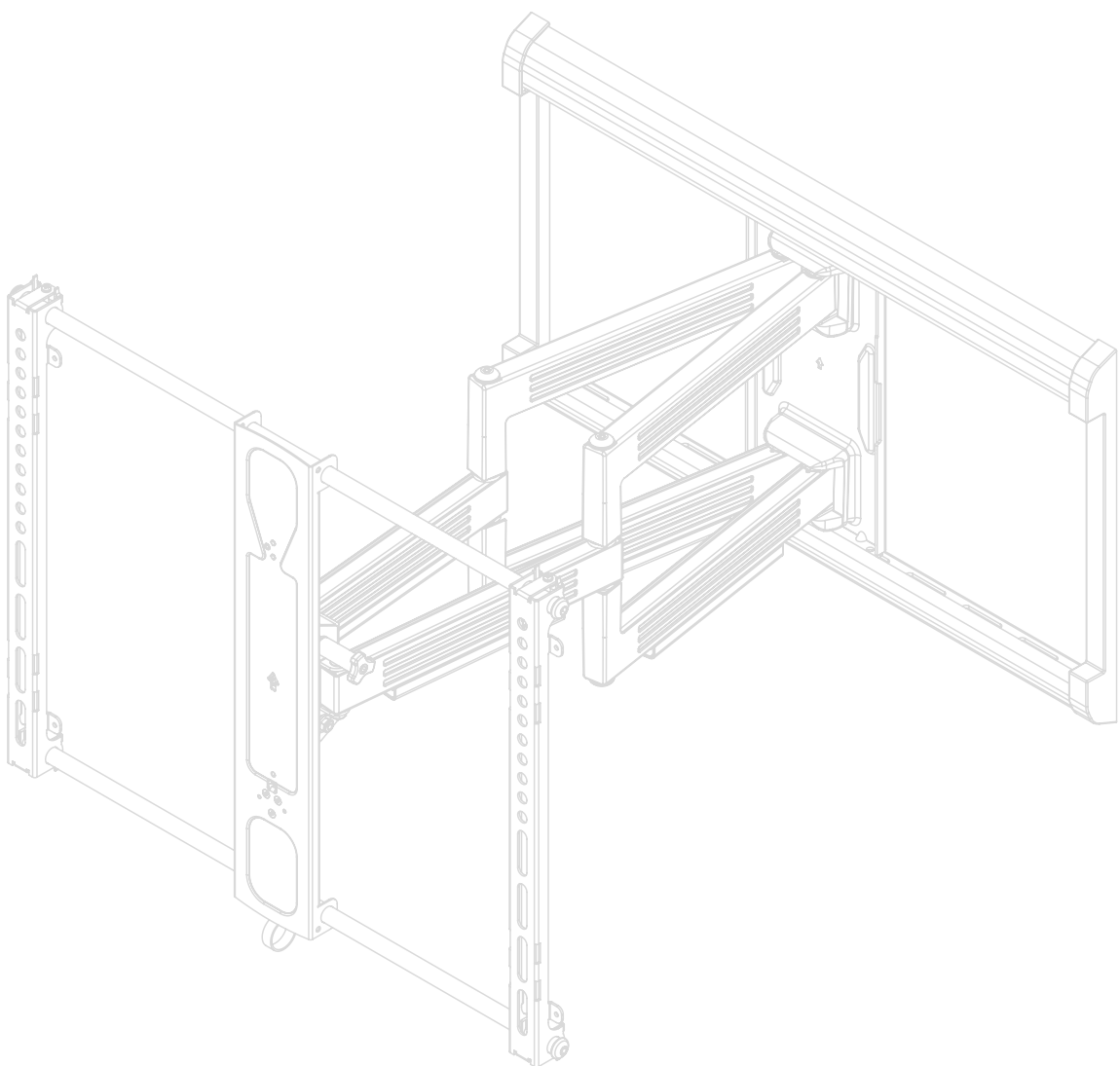

WALL PLATE

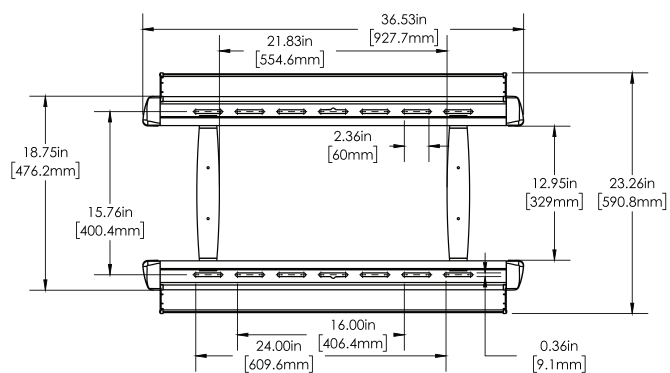

FULLY ASSEMBLED MOUNT

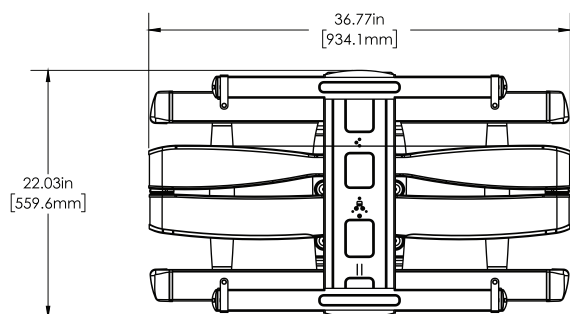

SANUS®

BLACK SERIES

Compatible with the SA809 large recessed wall box that holds up to six components.



MODEL
CILF226-B1

UPC
793795533876

MSRP
\$259.99

LIST PRICE
\$299.99

MOUNTING PATTERNS - VESA
Min: 200 x 200 | Max: 600 x 400

WEIGHT CAPACITY
135 lbs

DEPTH
2.4"

SUGGESTED TV SIZE RANGE
37"–80"

EXTENDS / TILTS
Extension: 26"; Tilt: +5° / -15°

PRODUCT DIMENSIONS
(w x d x h)
27.59" x 2.40" x 19.55"

PACKAGE DIMENSIONS
(w x d x h)
39.45" x 20.91" x 3.82"

PACKAGE WEIGHT
29.8 lbs

MASTER PACK QUANTITY
1

MASTER PACKAGE DIMENSIONS (w x d x h)
30.12" x 21.46" x 4.8"

MASTER PACKAGE WEIGHT
31.5 lbs

COMPATIBLE WITH
UP TO 2 CIASP1

CILF226 – LARGE FULL MOTION MOUNT



Virtual Axis™ fingertip tilt allows for easy TV adjustments and quick access to cables.



FluidMotion™ provides unparalleled smoothness and effortless TV movement.



Provides ultimate stability by firmly holding TV in the desired position.



Slim profile holds TV close to the wall for a sleek look.



Cable management channels secure cables along mount arm for a clean look.

SANUS®

BLACK SERIES

CILF226 – LARGE FULL MOTION MOUNT

TV INTERFACE - VESA

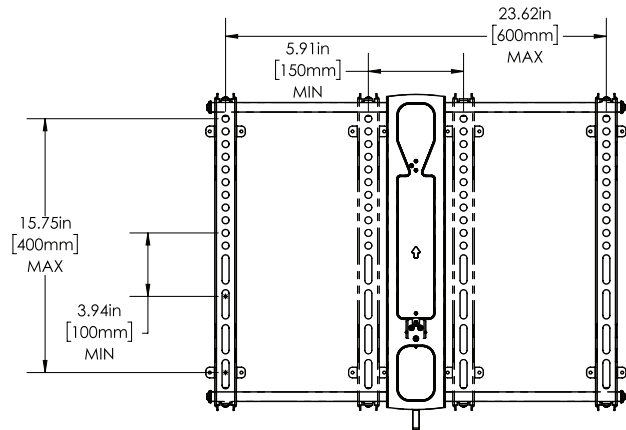

SIDE VIEW

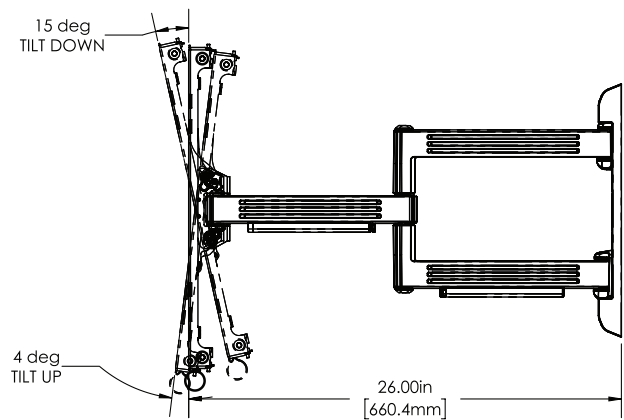

TOP VIEW - EXTENDED

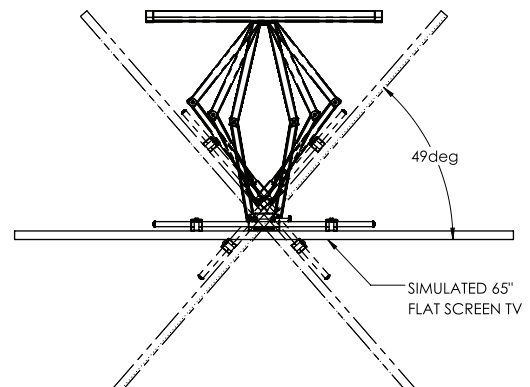

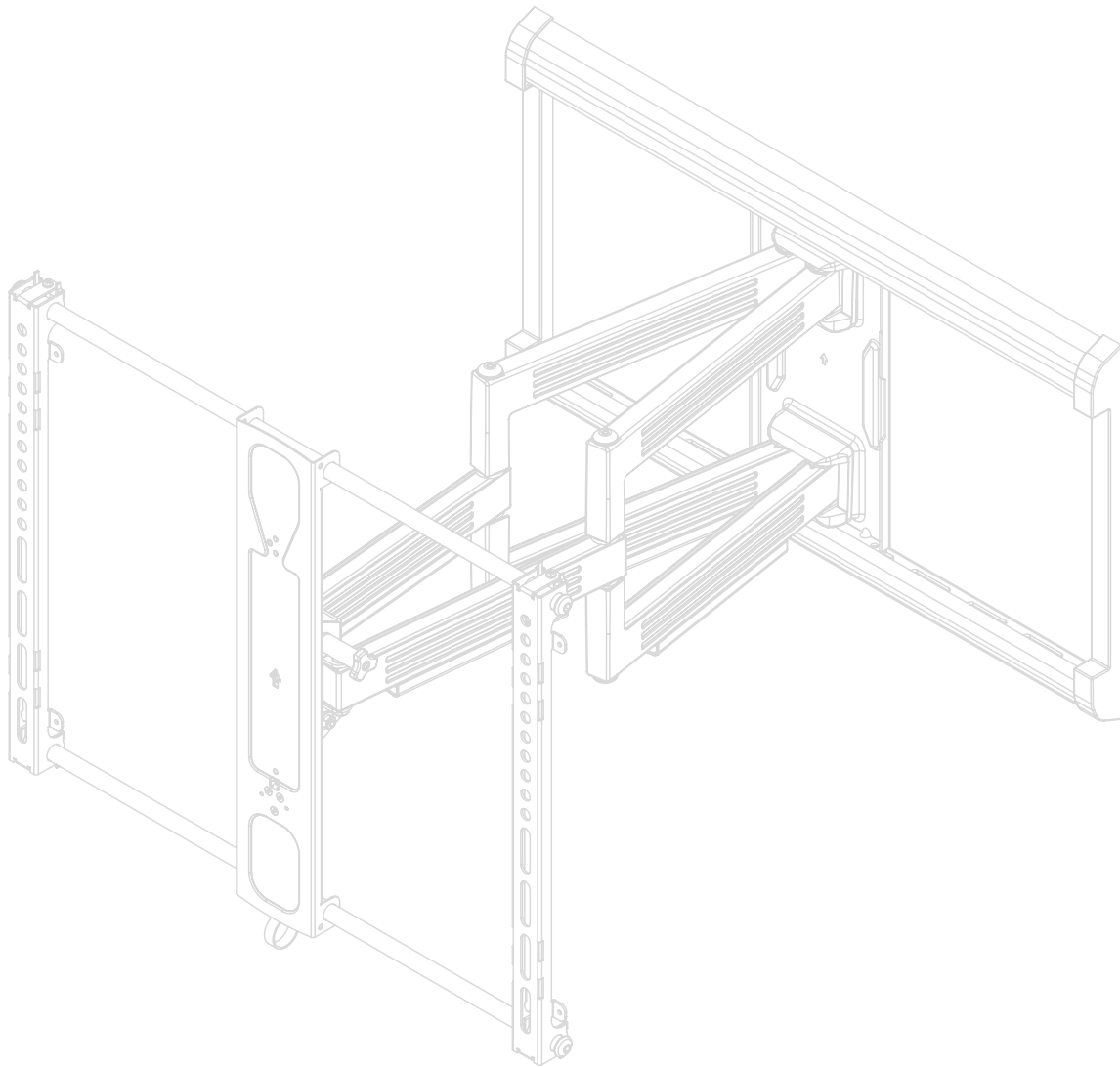

WALL PLATE

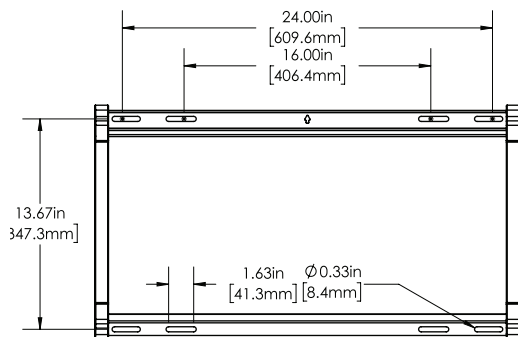

FULLY ASSEMBLED MOUNT

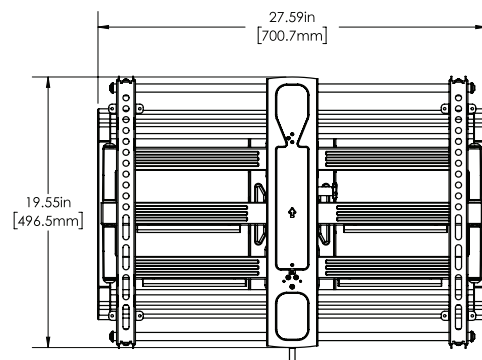

SANUS®

BLACK SERIES

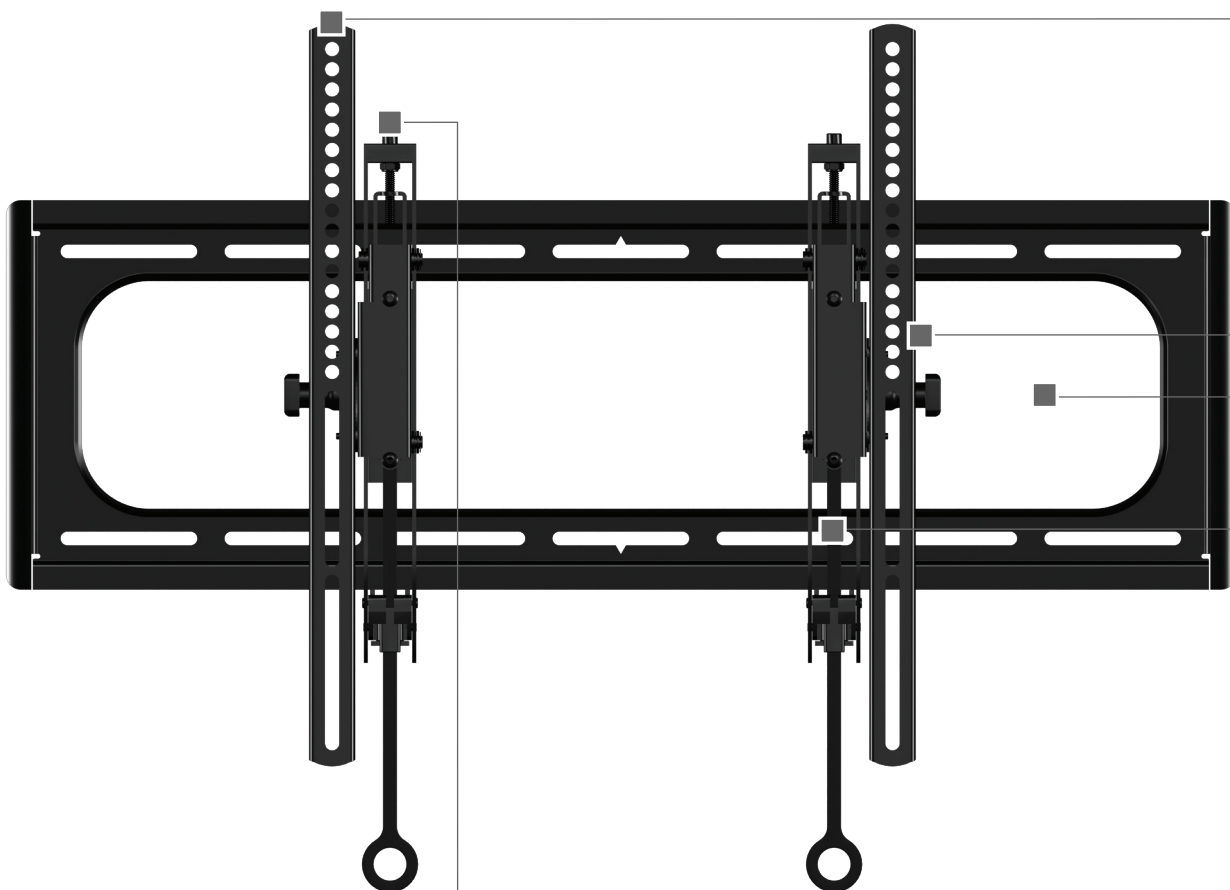

MODEL
CILT2-B1

UPC
793795530943

MSRP
\$184.99

LIST PRICE
\$279.99

MOUNTING PATTERNS - VESA
Min: 200 x 100 | Max: 690 x 415

WEIGHT CAPACITY
150 lbs

DEPTH
2.75"

SUGGESTED TV SIZE RANGE
37"–90"

EXTENDS / TILTS
Extension: 5.75"; Tilt: +7° / -12°

PRODUCT DIMENSIONS
(w x d x h)
30" x 2.74"–5.74" x 18.11"

PACKAGE DIMENSIONS
(w x d x h)
32.69" x 10.64" x 3.24"

PACKAGE WEIGHT
13.4 lbs

MASTER PACK QUANTITY
3

MASTER PACKAGE DIMENSIONS (w x d x h)
33.60" x 11.61" x 10.04"

MASTER PACKAGE WEIGHT
44.1 lbs

COMPATIBLE WITH
UP TO 1 CIASP1

CILT2 – LARGE ADVANCED TILT MOUNT



Offers maximum tilting range for large TVs.

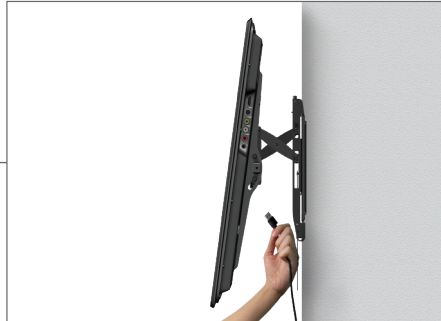

Mount extends 5.7" and tilts for easy cable access.

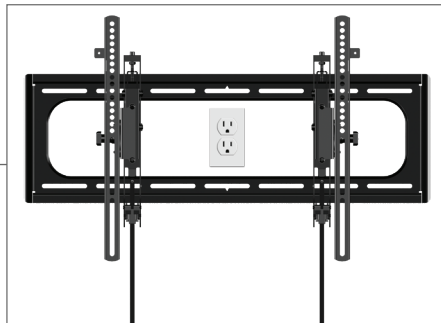

Open wall plate design allows mounting directly over electrical outlets.

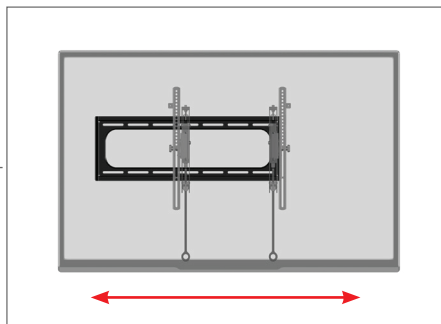

Slide TV side-to-side for perfect positioning on the wall.

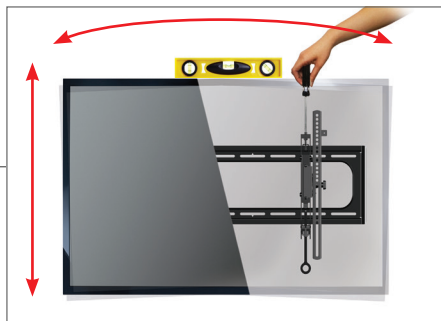

Easily adjust height and level after installation.

SANUS®

BLACK SERIES

CILT2 – LARGE ADVANCED TILT MOUNT

TV INTERFACE - VESA

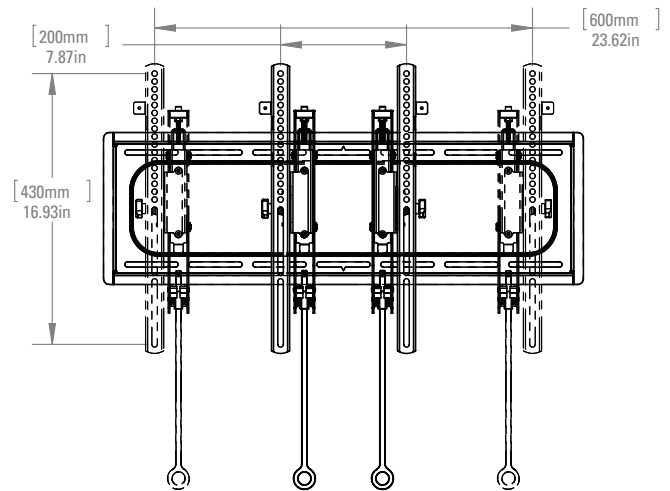

SIDE VIEW

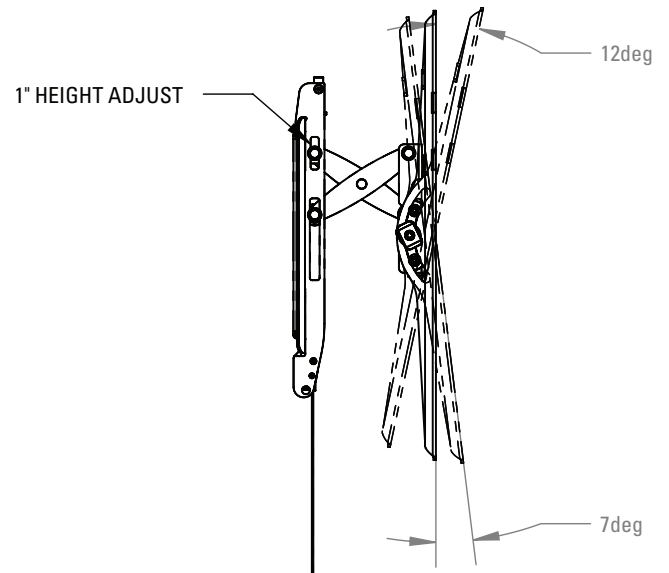

TOP VIEW - EXTENDED

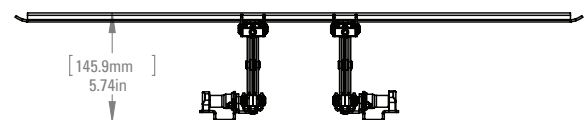

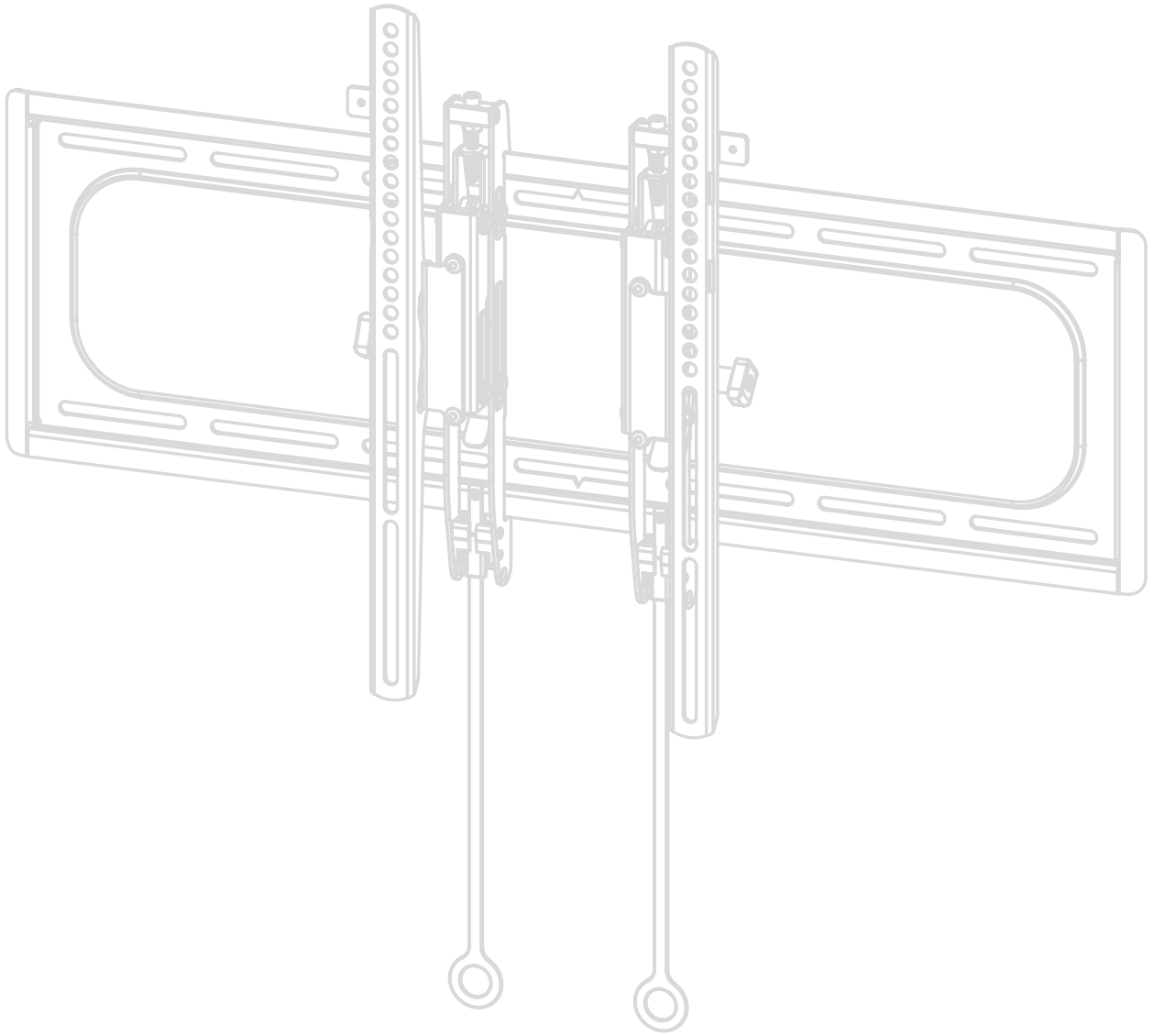

WALL PLATE

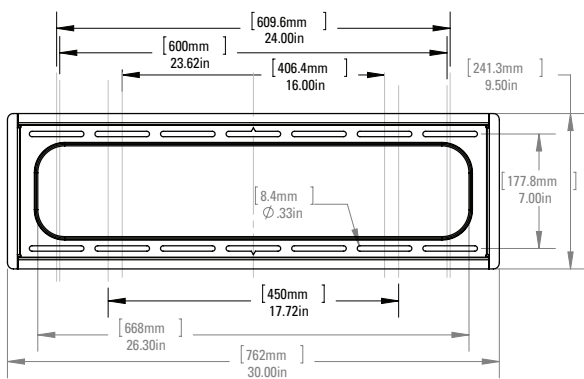

FULLY ASSEMBLED MOUNT

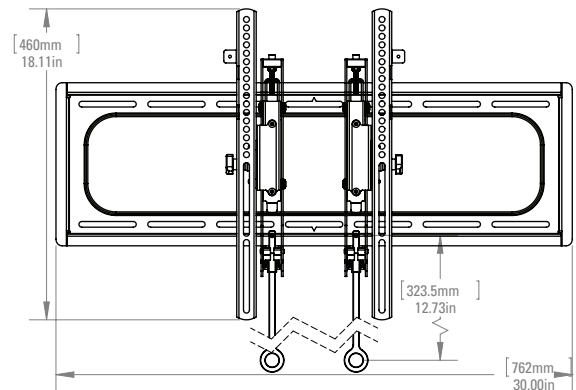

SANUS®

BLACK SERIES

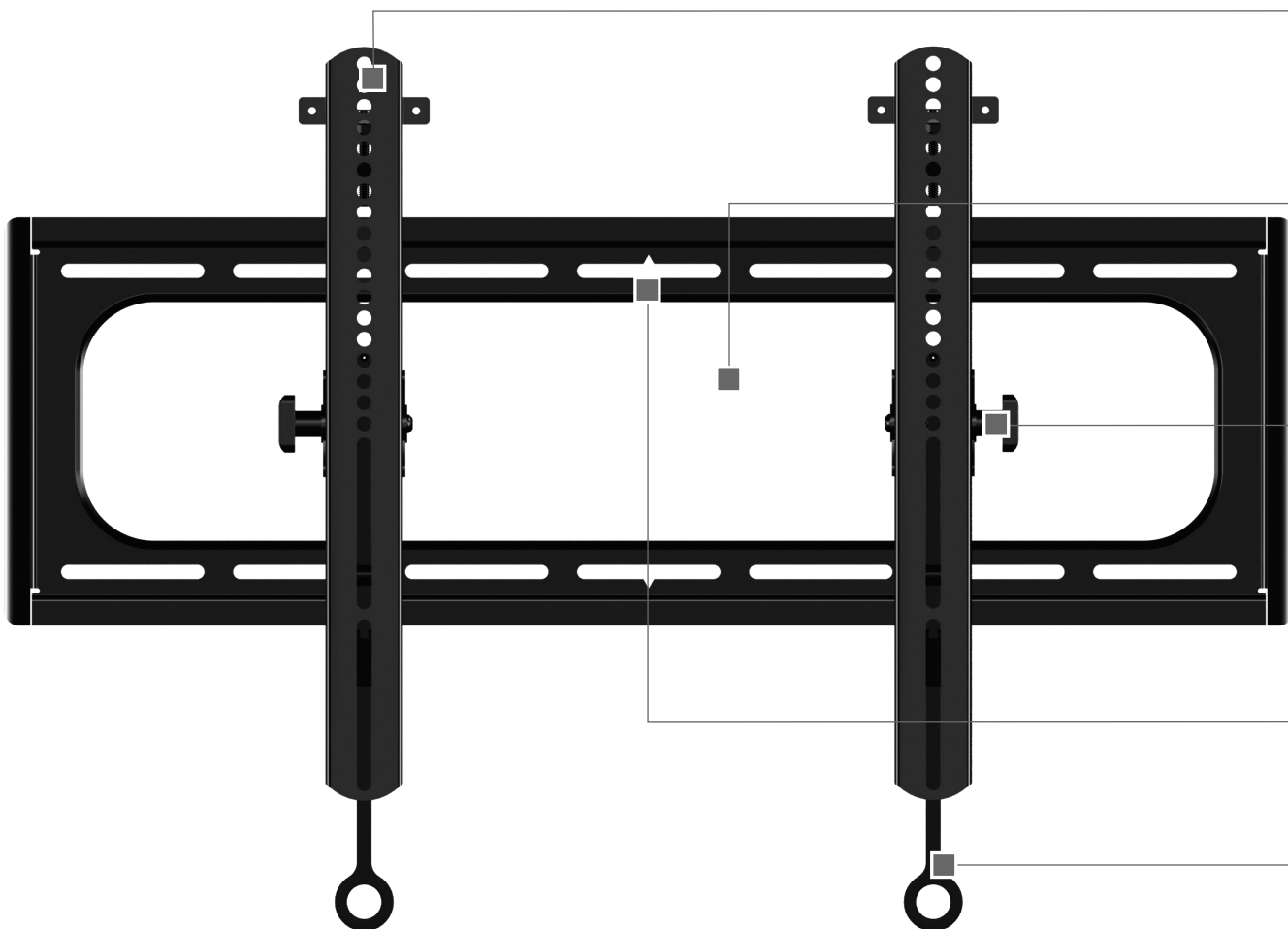

MODEL
CILT1-B1

UPC
793795529831

MSRP
\$154.99

LIST PRICE
\$249.99

MOUNTING PATTERNS - VESA
Min: 200 x 200 | Max: 690 x 415

WEIGHT CAPACITY
180 lbs

DEPTH
2.2"

SUGGESTED TV SIZE RANGE
37"–95"

TILTS
+7°/-10°

PRODUCT DIMENSIONS
(w x d x h)
30" x 2.18" x 17.53"

PACKAGE DIMENSIONS
(w x d x h)
32.69" x 10.64" x 3.24"

PACKAGE WEIGHT
12.3 lbs

MASTER PACK QUANTITY
3

MASTER PACKAGE DIMENSIONS (w x d x h)
33.6" x 11.68" x 10.04"

MASTER PACKAGE WEIGHT
40.1 lbs

**COMPATIBLE WITH
UP TO 2 CIASP1**

CILT1 – LARGE TILTING MOUNT

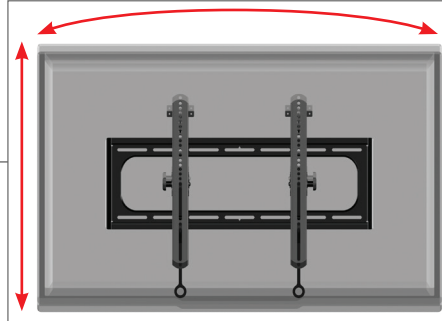

New ProSet Plus™ post install height and level adjustments allow for up to one full inch of height and level adjustment.

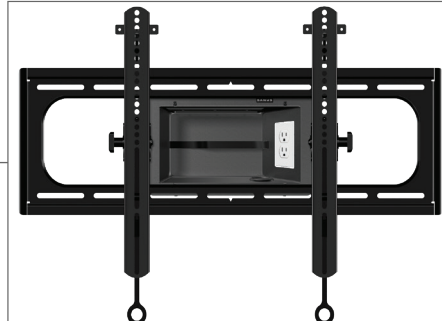

Open wall plate design allows mounting directly over most wall boxes and electrical outlets.

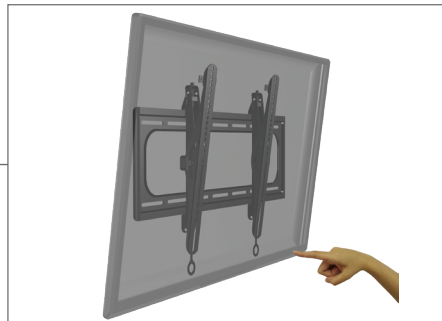

Virtual Axis™ Fingertip tilt allows for easy TV adjustments and quick access to cables.

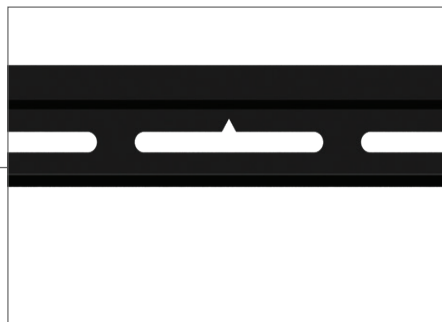

Save time by using the leveling notch to hang the wall plate on a temporary nail while leveling the wall plate and marking holes to drill.

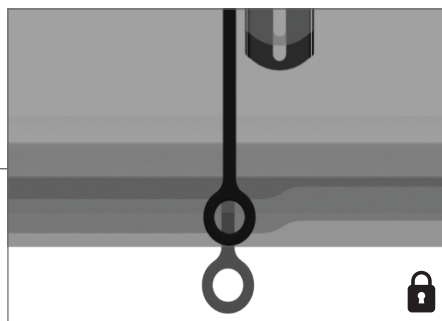

High quality Quick-Release tabs instantly unlock the TV from the wall plate and adjust to line up with the bottom of the TV. Optional padlock adds security.

BLACK SERIES

CILT1 – LARGE TILTING MOUNT

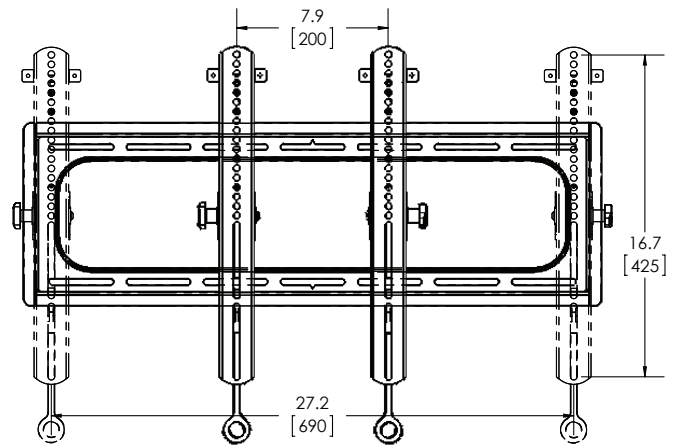

SIDE VIEW - HEIGHT ADJUSTMENT

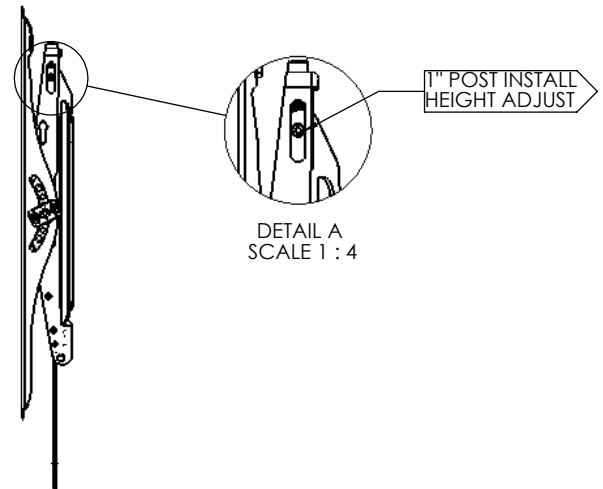

FRONT VIEW

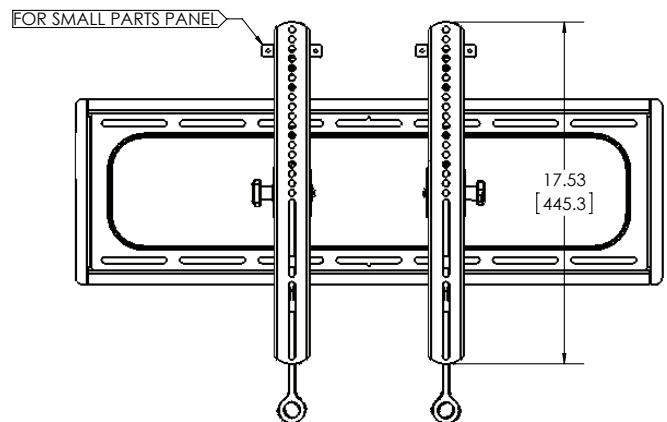

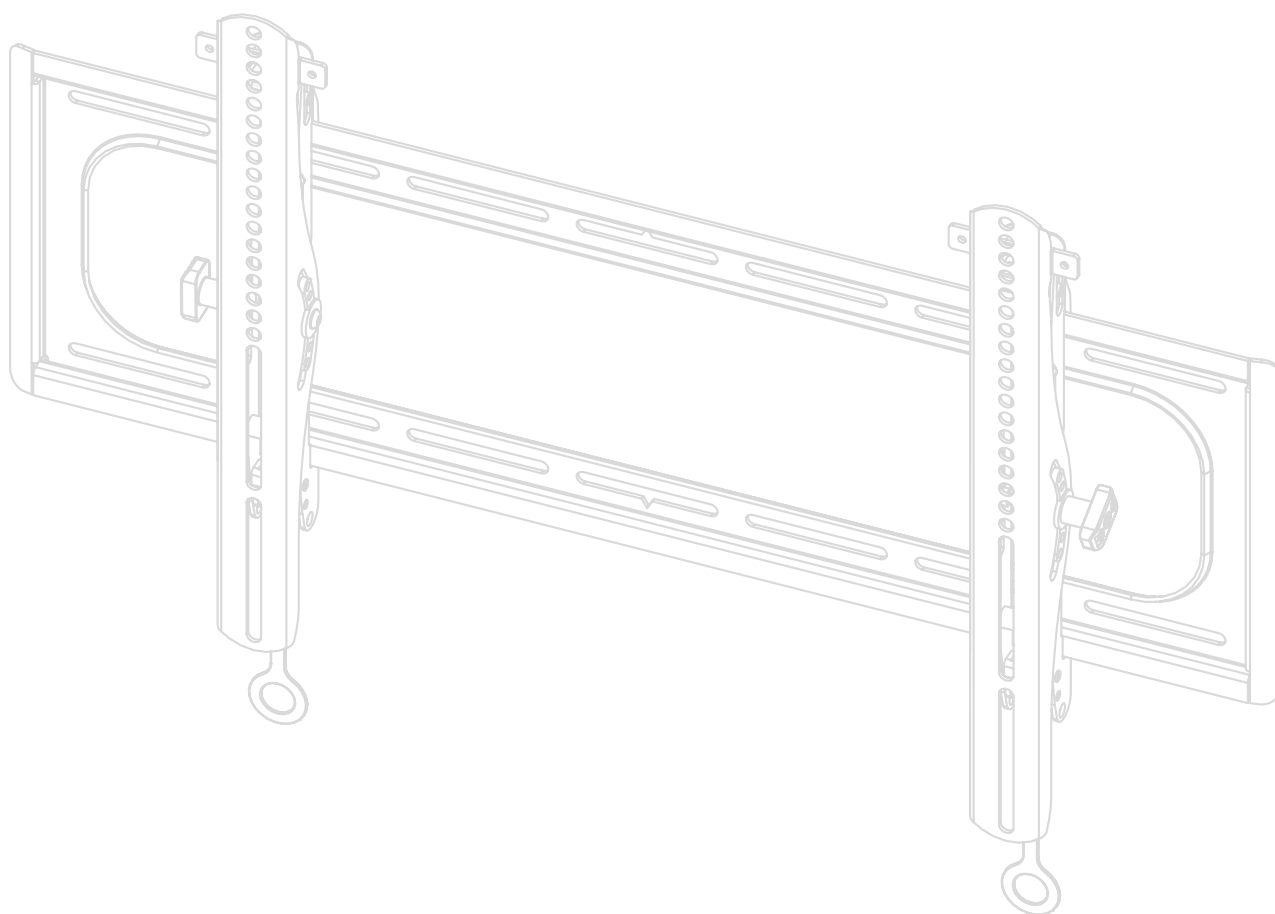

WALL PLATE

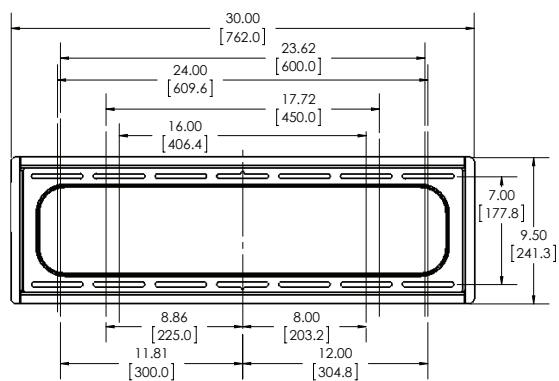

WALL PLATE OPENING

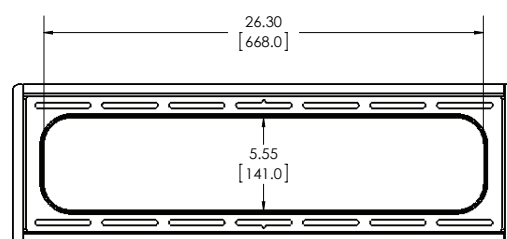

SANUS®

BLACK SERIES

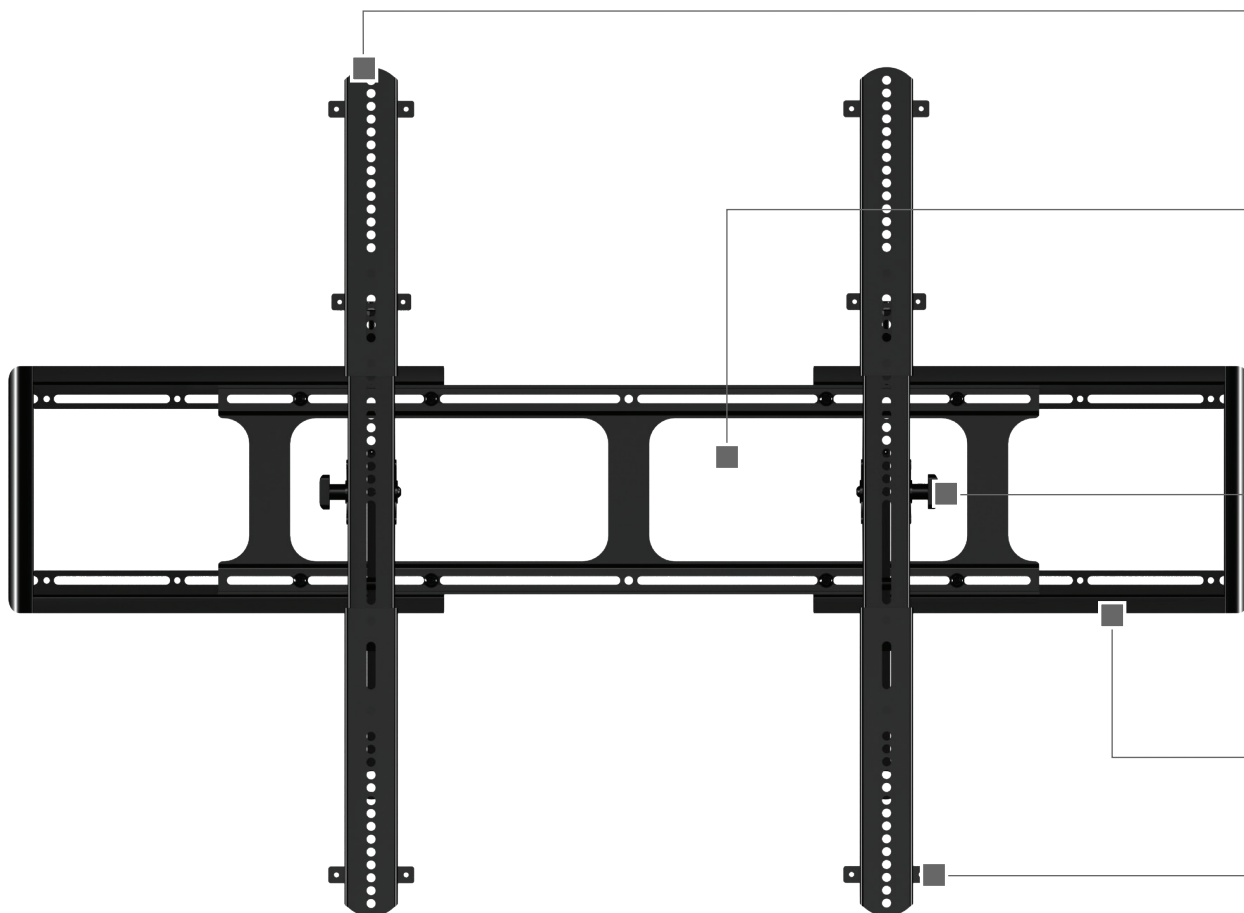

MODEL
CIXT1-B1

UPC
793795529848

MSRP
\$204.99

LIST PRICE
\$299.99

MOUNTING PATTERNS - VESA
Min: 200 x 200 | Max: 1100 x 800

WEIGHT CAPACITY
300 lbs

DEPTH
2.5"

SUGGESTED TV SIZE RANGE
40"-110"

TILTS
+7°/-10°

PRODUCT DIMENSIONS
(w x d x h)
33.43"-52.93" x 2.41" x 17.53"-32.49"

PACKAGE DIMENSIONS
(w x d x h)
36.59" x 10.88" x 3.32"

PACKAGE WEIGHT
21 lbs

MASTER PACK QUANTITY
2

MASTER PACKAGE DIMENSIONS (w x d x h)
33.6" x 11.68" x 7.31"

MASTER PACKAGE WEIGHT
44.4 lbs

COMPATIBLE WITH
UP TO 2 CIASP1

CIXT1 – EXTRA LARGE TILTING MOUNT

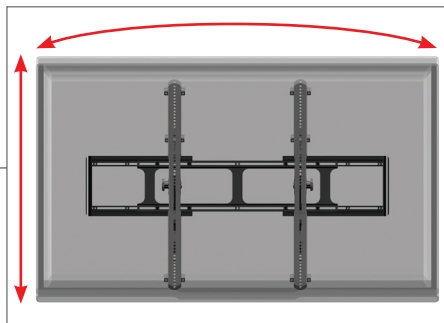

New ProSet Plus™ post install height and level adjustments allow for up to one full inch of height and level adjustment.

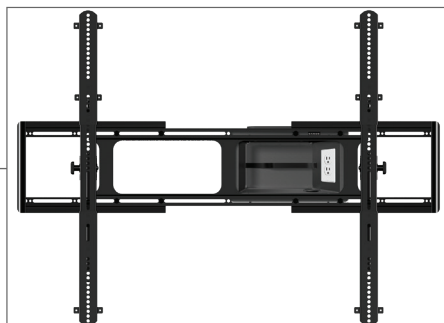

Open wall plate design allows mounting directly over most wall boxes and electrical outlets.

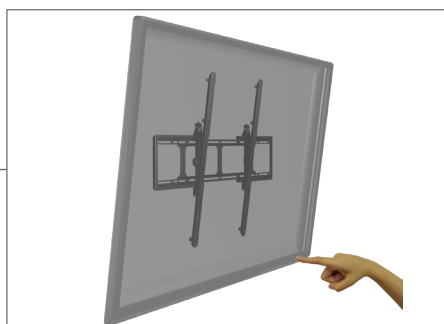

Virtual Axis™ Fingertip tilt allows for easy TV adjustments and quick access to cables.

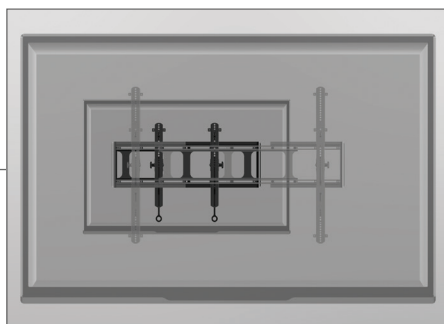

CIXT1 comes with extender brackets that easily attach to accommodate large hole patterns. Brackets are also compatible with CILT1 and CILL1.

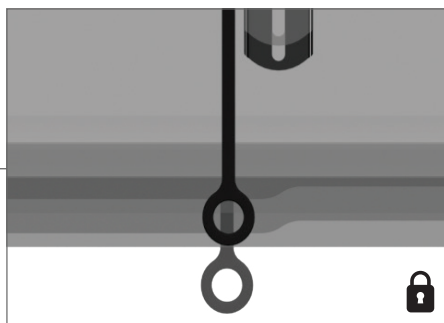

High quality Quick-Release tabs instantly unlock the TV from the wall plate and adjust to line up with the bottom of the TV. Optional padlock adds security.

BLACK SERIES

CIXT1 – EXTRA LARGE TILTING MOUNT

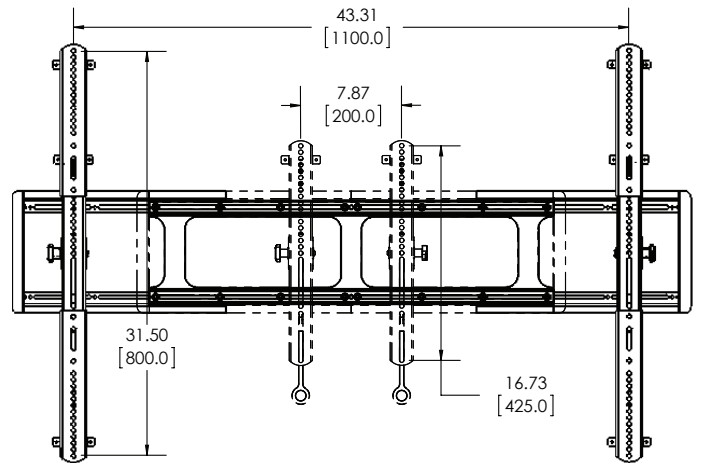

SIDE VIEW - HEIGHT ADJUSTMENT

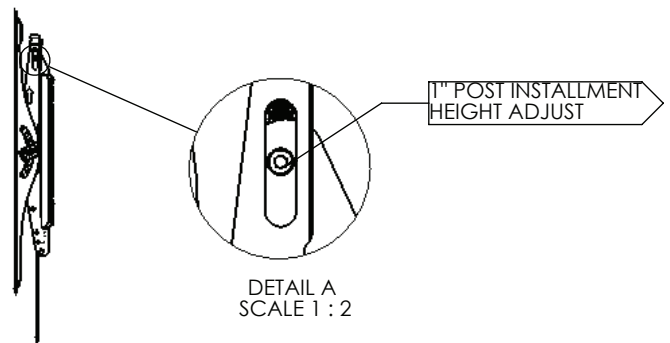

FRONT VIEW

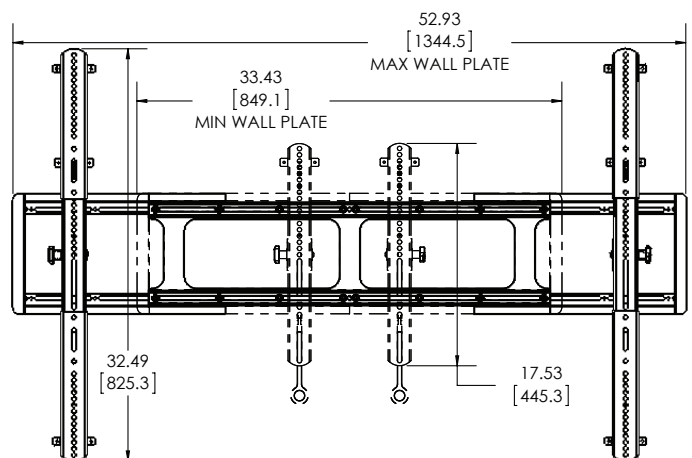

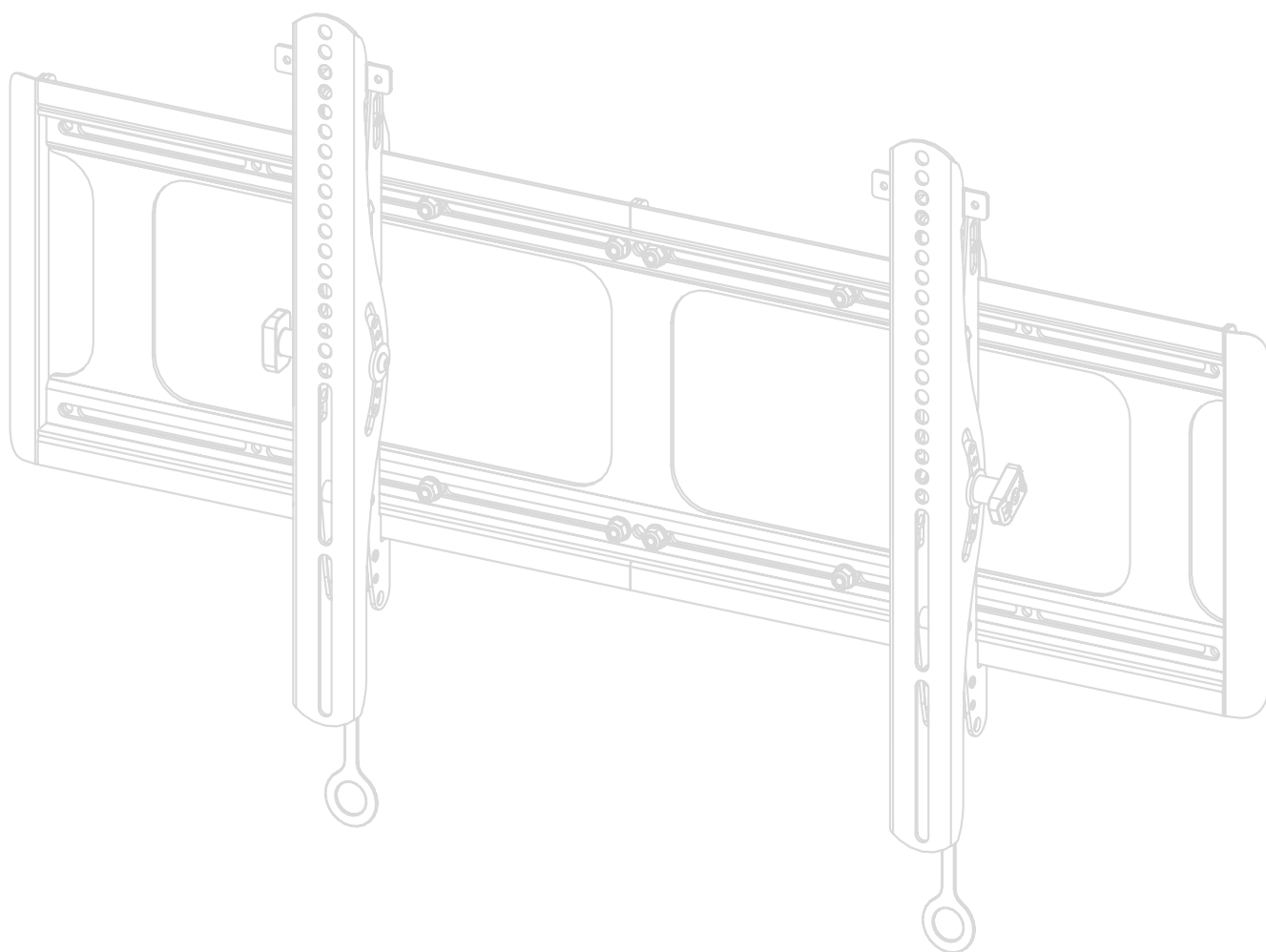

WALL PLATE

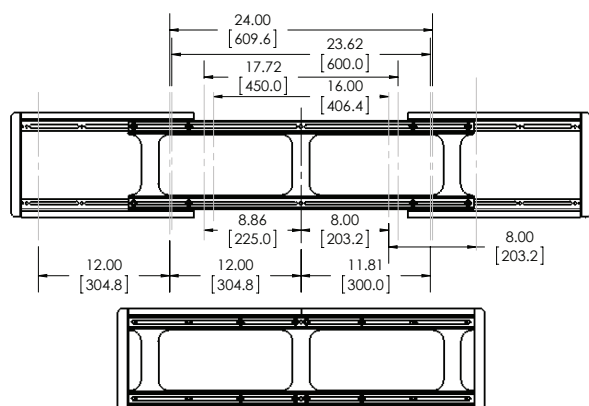

WALL PLATE OPENING

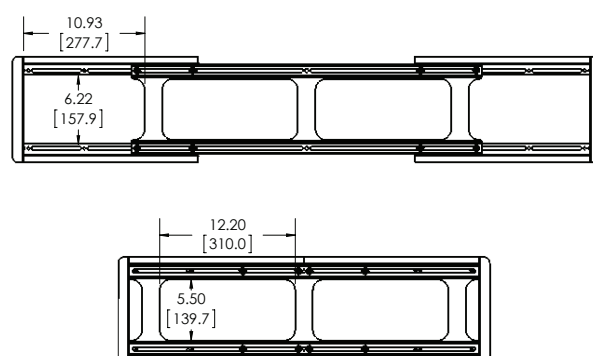

SANUS®

BLACK SERIES

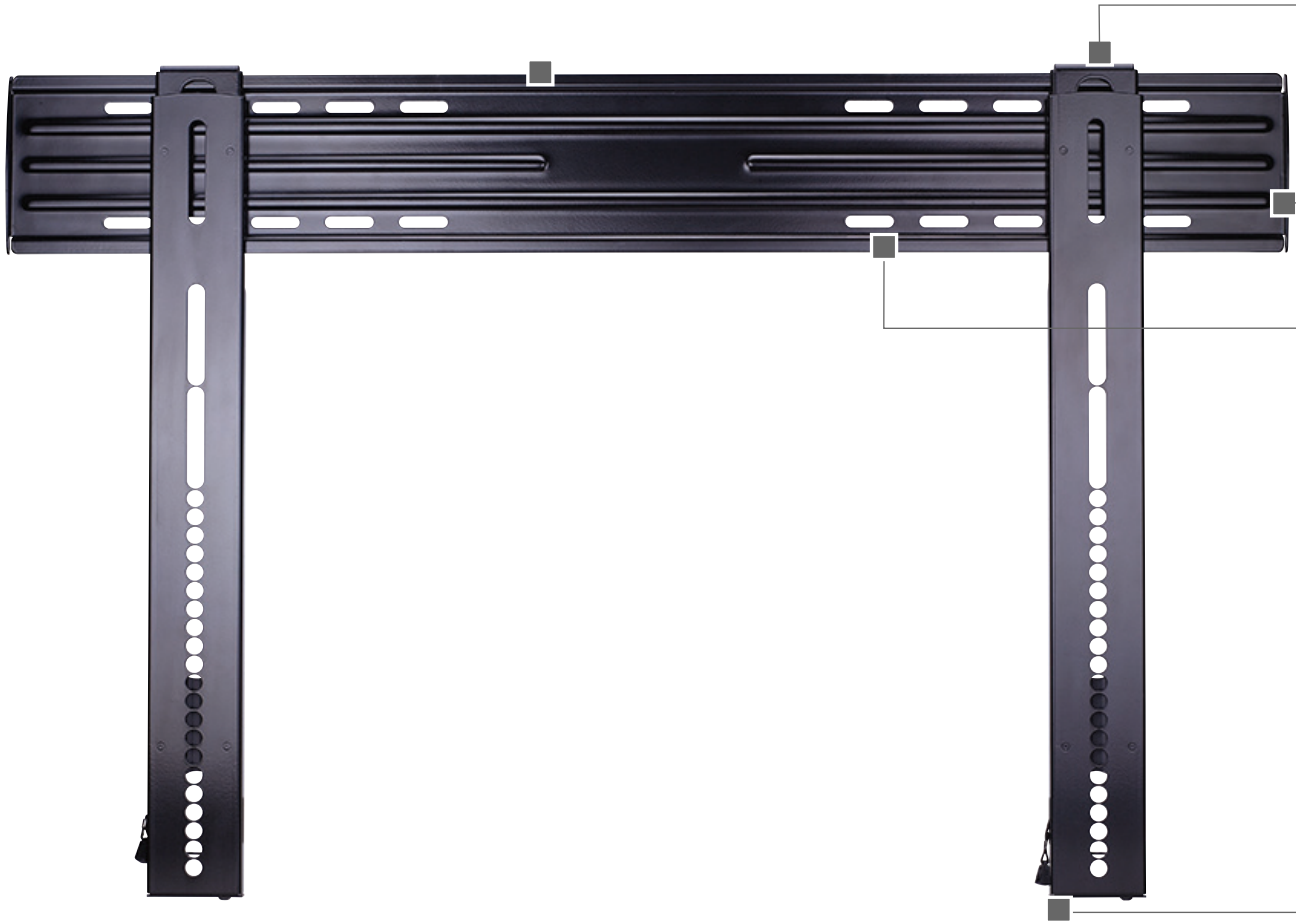

MODEL
CILL2-B1

UPC
793795531537

MSRP
\$109.99

LIST PRICE
\$199.99

MOUNTING PATTERNS - VESA
Min: 100 x 100 | Max: 825 x 500

WEIGHT CAPACITY
150 lbs

DEPTH
0.55"

SUGGESTED TV SIZE RANGE
37"–90"

PRODUCT DIMENSIONS
(w x d x h)
35.26" x 0.55" x 22.10"

PACKAGE DIMENSIONS
(w x d x h)
38.31" x 7.11" x 2.01"

PACKAGE WEIGHT
11.7 lbs

MASTER PACK QUANTITY
3

MASTER PACKAGE DIMENSIONS (w x d x h)
33.6" x 8.23" x 6.45"

MASTER PACKAGE WEIGHT
36.5 lbs

**COMPATIBLE WITH
UP TO 1 CIASP1**

CILL2 – LARGE FIXED MOUNT



Easily adjust height and level after installation.

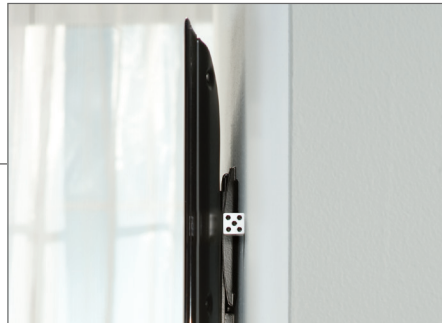

Super Slim mount places TV just 0.55" from wall.



Slide TV side-to-side for perfect positioning on the wall.



Safety tab and click stands provide a secure connection and easy access to your cables.

SANUS®

BLACK SERIES

CILL2 – LARGE FIXED MOUNT

TV INTERFACE - VESA

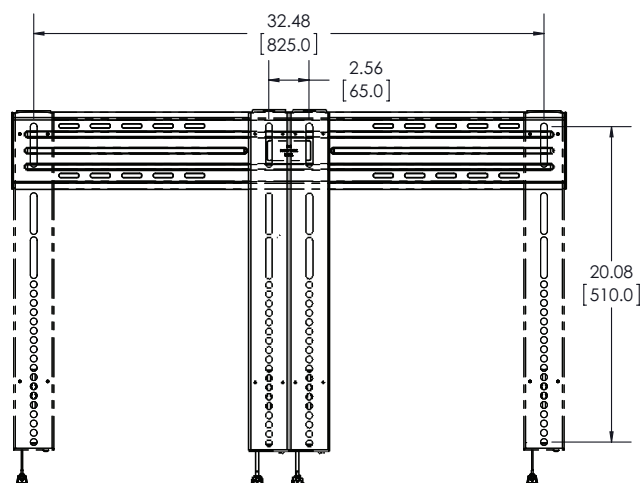

SIDE VIEW

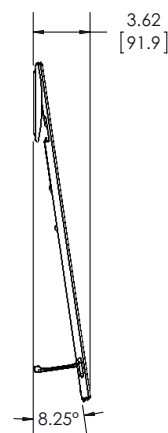

TOP VIEW - RETRACTED



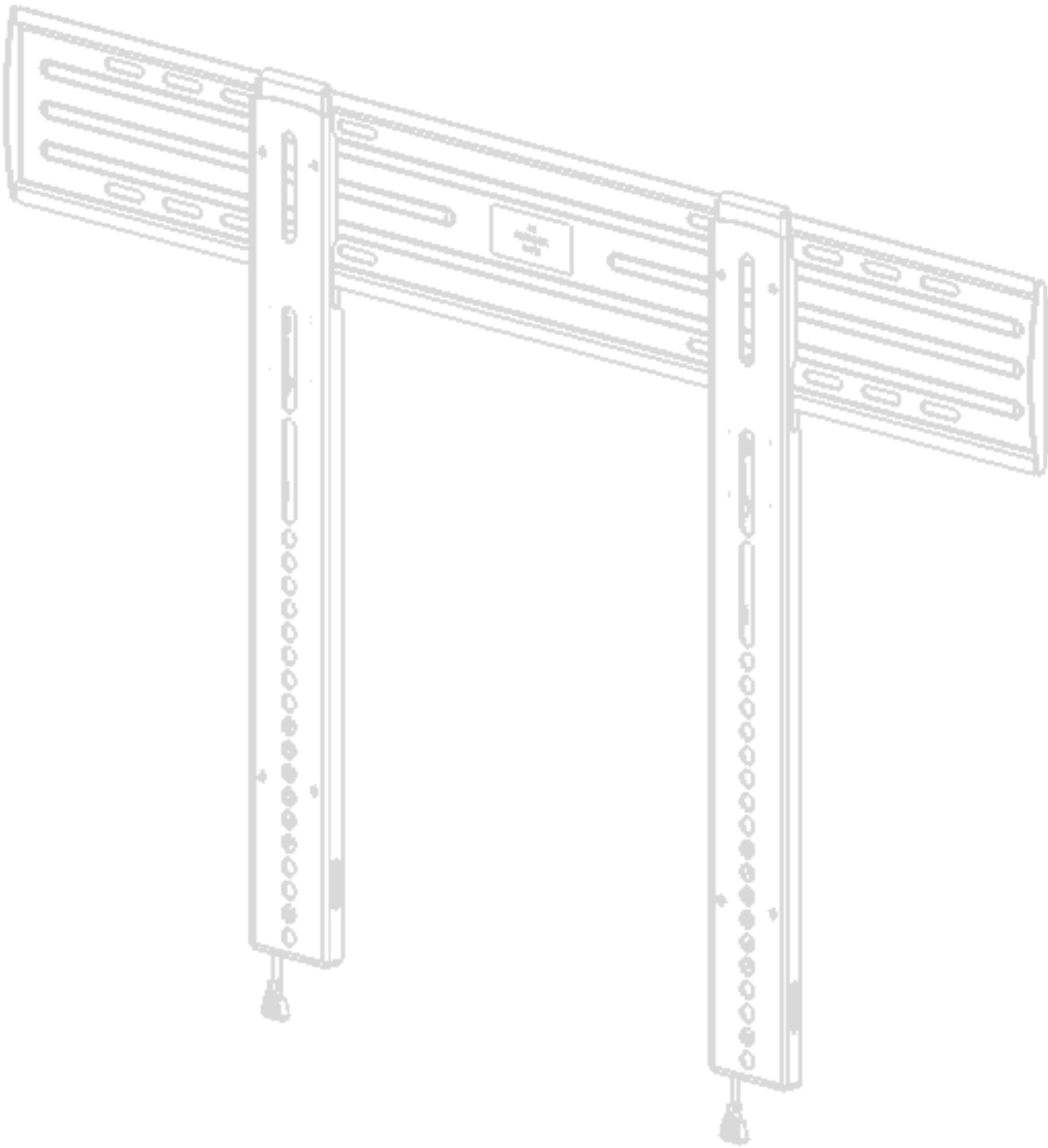

WALL PLATE

FULLY ASSEMBLED MOUNT

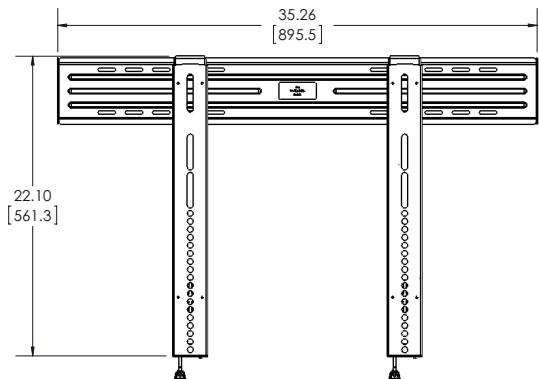
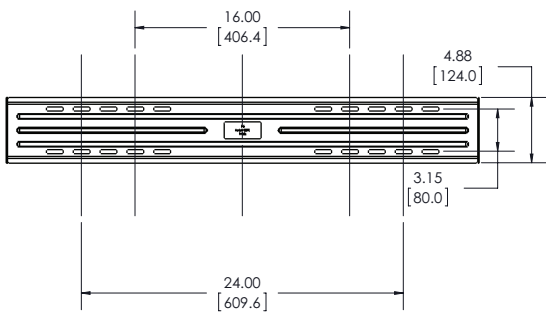

SANUS®

BLACK SERIES

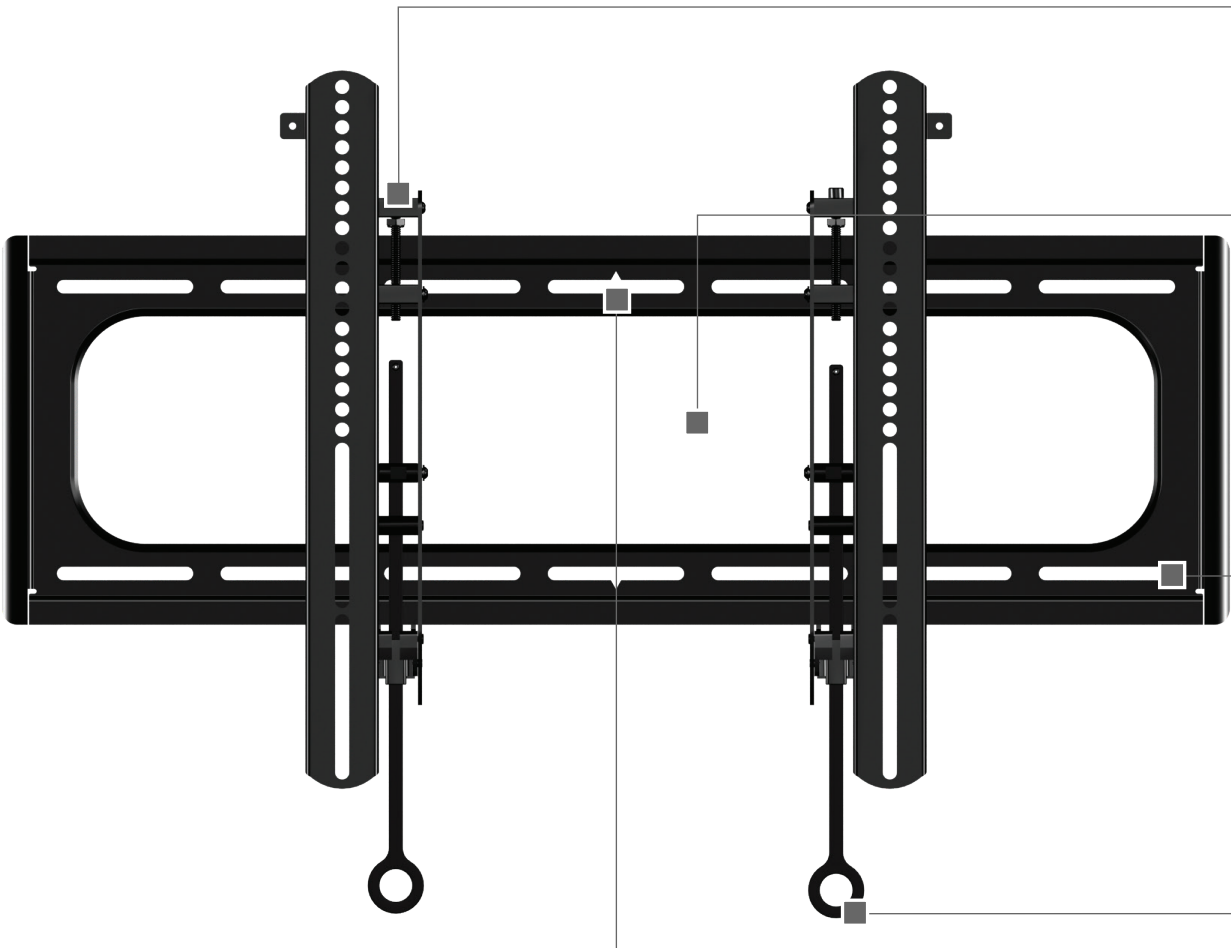

MODEL
CILL1-B1

UPC
793795529824

MSRP
\$99.99

LIST PRICE
\$199.99

MOUNTING PATTERNS - VESA
Min: 200 x 200 | Max: 690 x 415

WEIGHT CAPACITY
180 lbs

DEPTH
1.6"

SUGGESTED TV SIZE RANGE
37"–95"

LOW PROFILE
Sits 1.6" from the wall

PRODUCT DIMENSIONS
(w x d x h)
30" x 1.6" x 17.53"

PACKAGE DIMENSIONS
(w x d x h)
32.74" x 10.76" x 3.12"

PACKAGE WEIGHT
11.6 lbs

MASTER PACK QUANTITY
3

MASTER PACKAGE DIMENSIONS (w x d x h)
33.6" x 11.55" x 9.97"

MASTER PACKAGE WEIGHT
37 lbs

COMPATIBLE WITH
UP TO 2 CIASP1

CILL1 – LARGE FIXED MOUNT

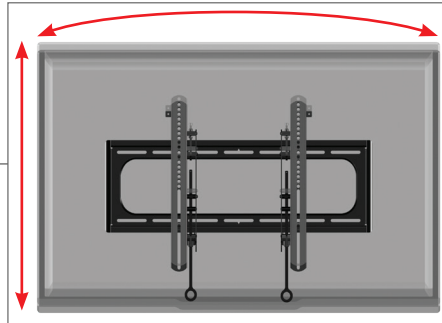

New ProSet Plus™ post install height and level adjustments allow for up to one full inch of height and level adjustment.

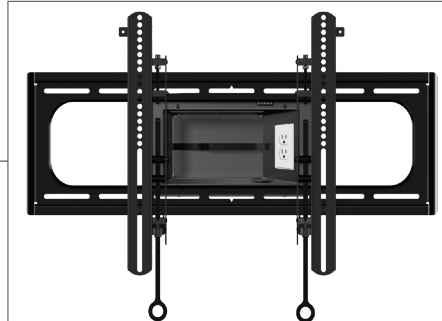

Open wall plate design allows mounting directly over most wall boxes and electrical outlets.



Slim profile allows mount to sit just 1.6" from the wall.

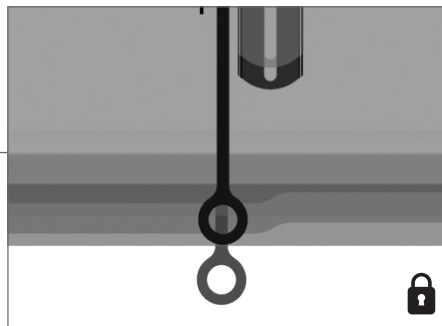

High quality Quick-Release tabs instantly unlock the TV from the wall plate and adjust to line up with the bottom of the TV. Optional padlock adds security.

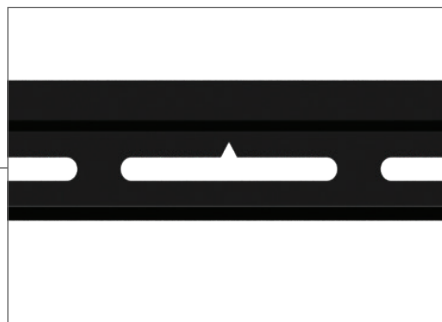

Save time by using the leveling notch to hang the wall plate on a temporary nail while leveling the wall plate and marking holes to drill.

SANUS®

BLACK SERIES

CILL1 – LARGE FIXED MOUNT

TV INTERFACE - VESA

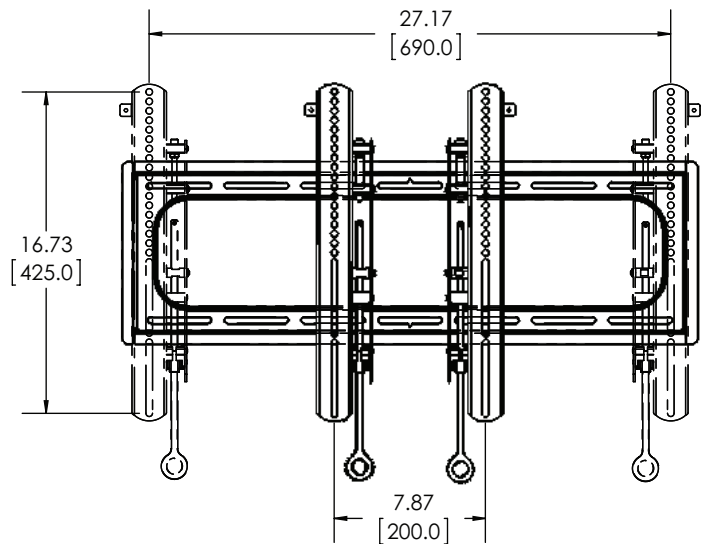

SIDE VIEW - HEIGHT ADJUSTMENT

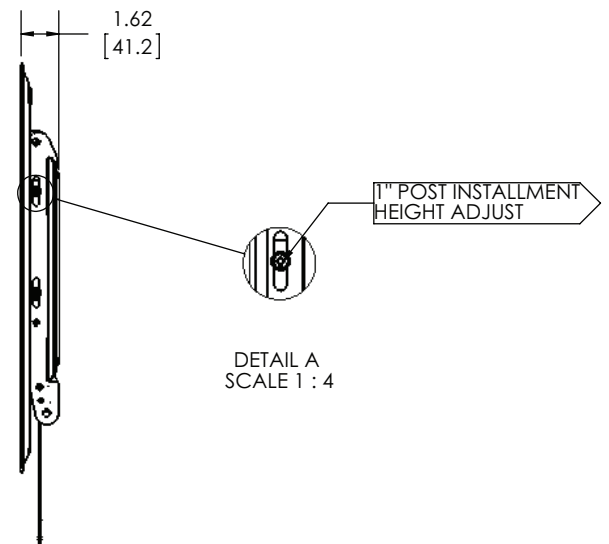

FRONT VIEW

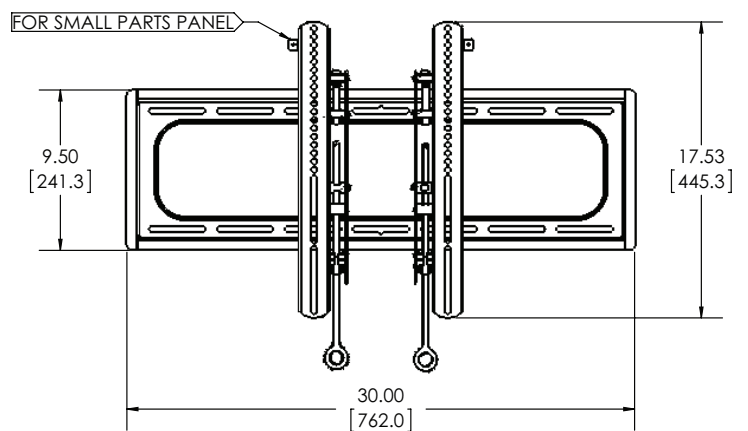

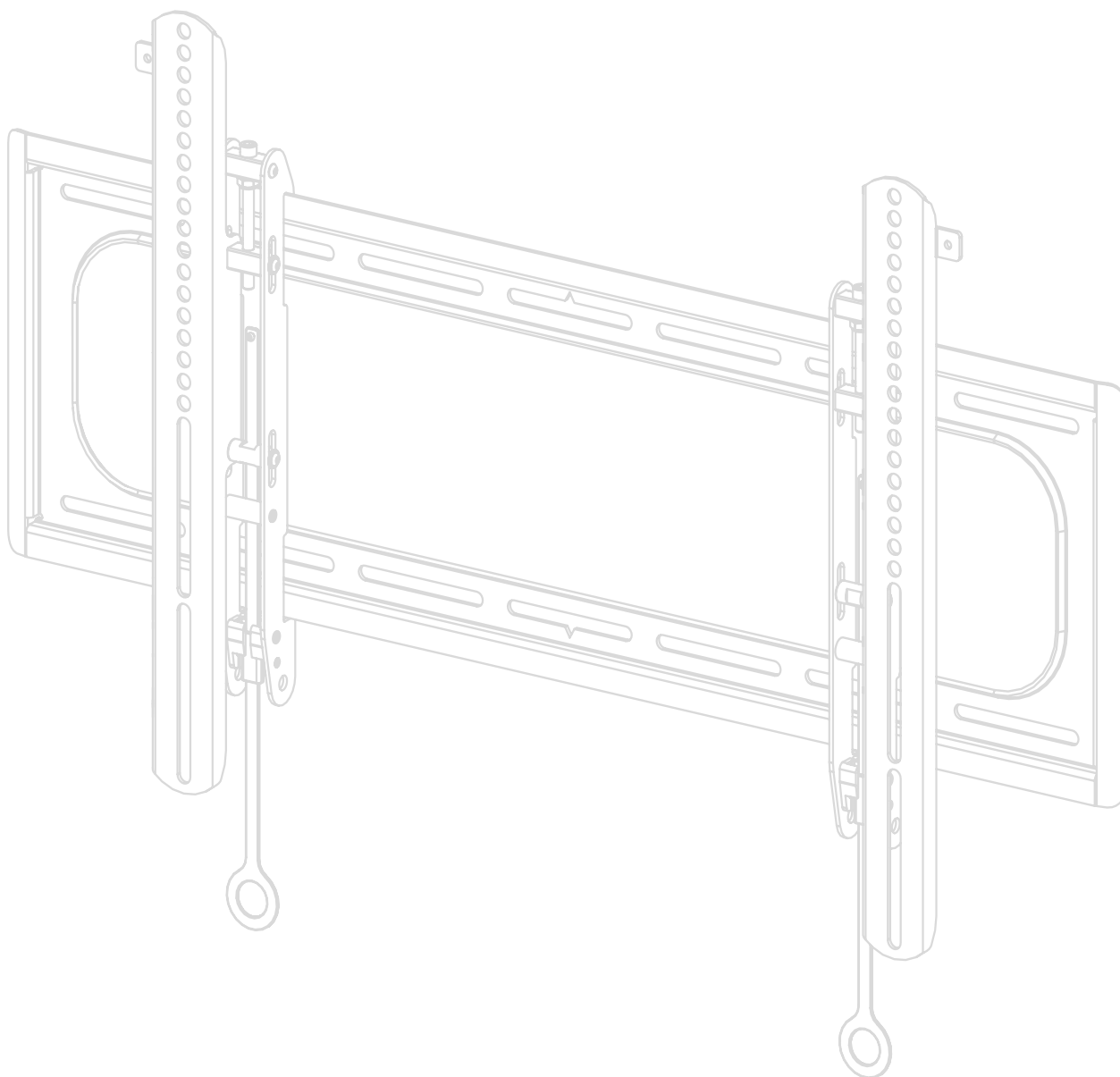

WALL PLATE

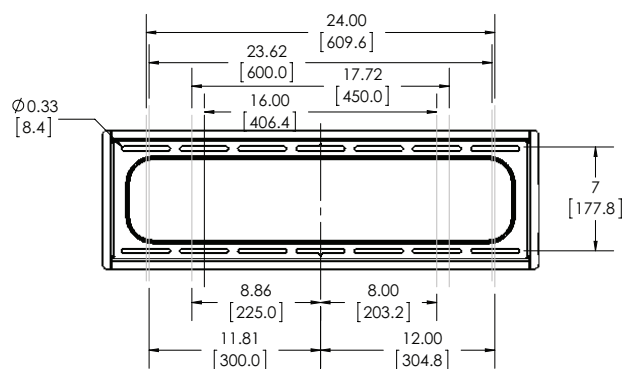

WALL PLATE OPENING

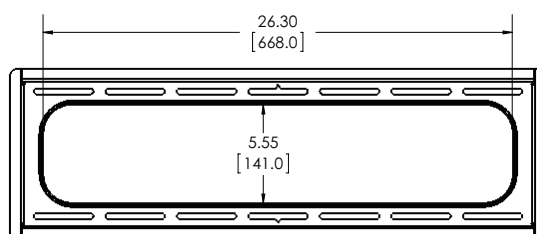

SANUS®

BLACK SERIES

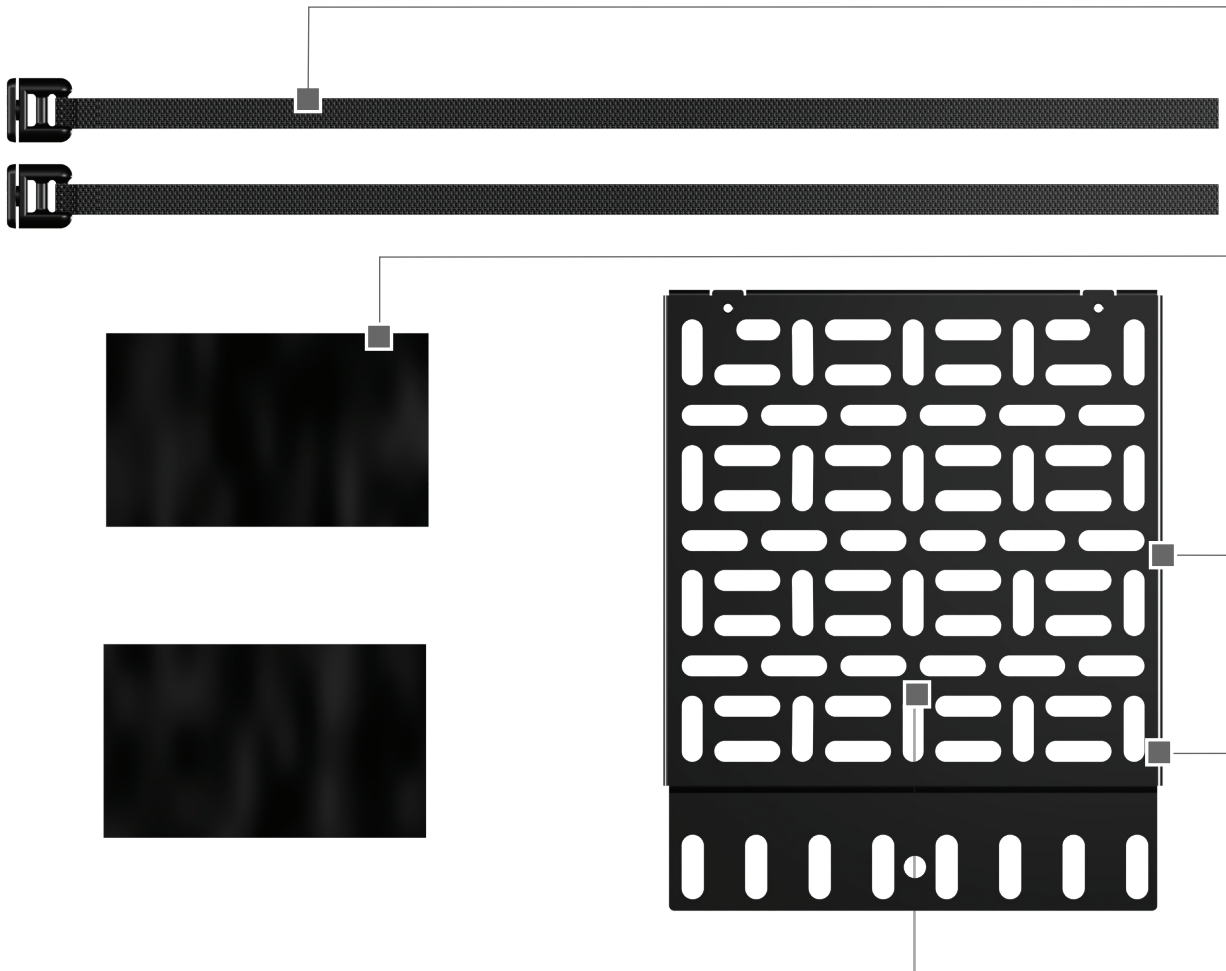

MODEL
CIASP1-B1

UPC
793795529817

MSRP
\$29.99

LIST PRICE
\$39.99

COMPATIBILITY
All SANUS Black TV Mounts

WEIGHT CAPACITY
15 lbs

PRODUCT DIMENSIONS
(w x d x h)
7.74" x 0.38" x 9.62"

PACKAGE DIMENSIONS
(w x d x h)
10.84" x 8.15" x 1.46"

PACKAGE WEIGHT
1.39 lbs

MASTER PACK QUANTITY
8

MASTER PACKAGE DIMENSIONS (w x d x h)
17.34" x 11.52" x 6.88"

MASTER PACKAGE WEIGHT
12.76 lbs

CIASP1 – SMALL PARTS PANEL



Two twist on hook and loop tie down fasteners can be located and oriented anywhere on the panel. Can be attached to itself, the panel or another tie down fastener as a support or tie down.



Stick on anti-slide material can be cut to size for secure no-slip mounting.

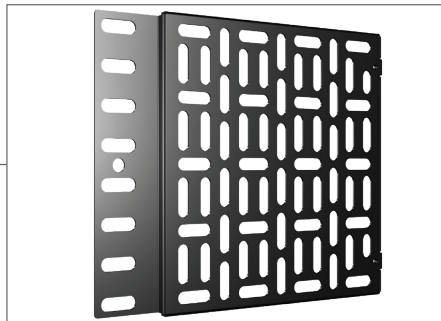

Raised panel for ventilation.

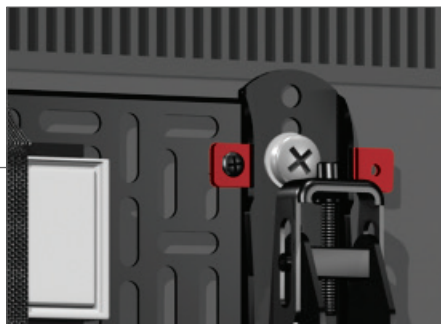

Special small parts tab to securely fasten the CIASP1 to the TV interface.



Secures streaming devices like Apple TV®, Roku®, DirecTV Genie™, TiVo® mini, Sonos® CONNECT:AMP™, network switchers, HDMI baluns, control processors and signal converters.

BLACK SERIES

CIASP1 – SMALL PARTS PANEL

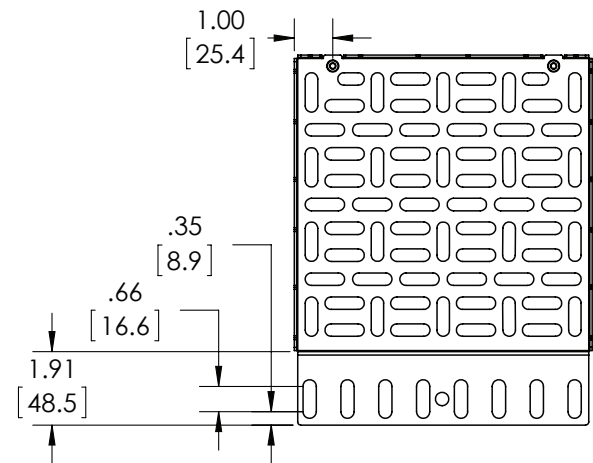
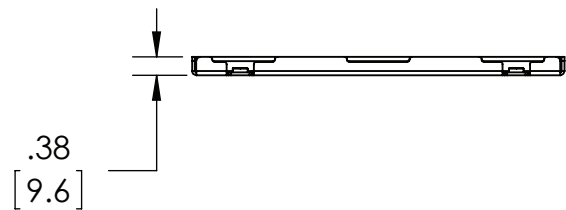
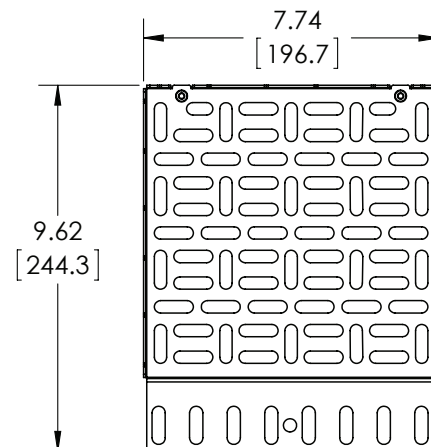
TV INTERFACE**SIDE VIEW****FRONT VIEW**

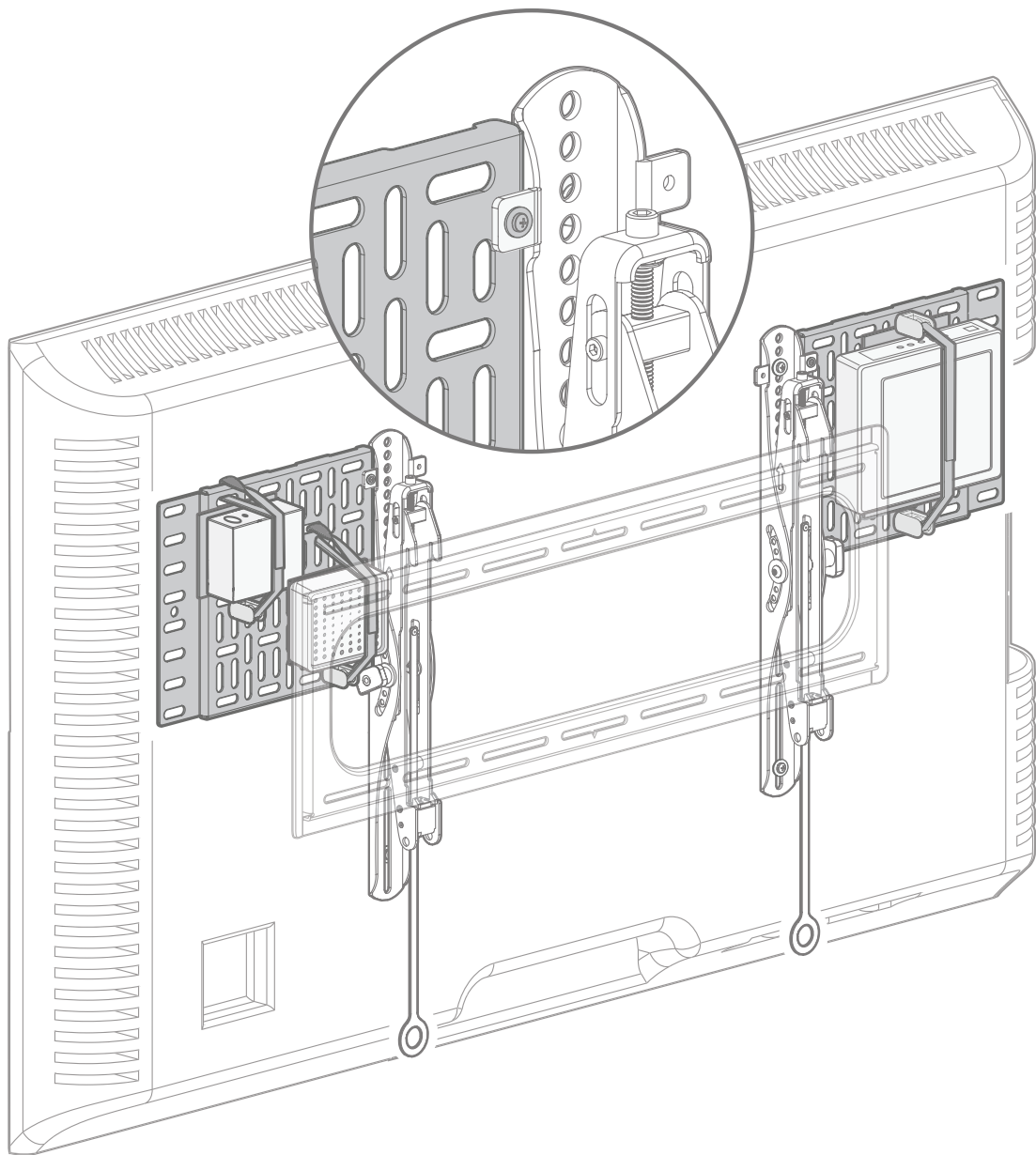

WALL PLATE

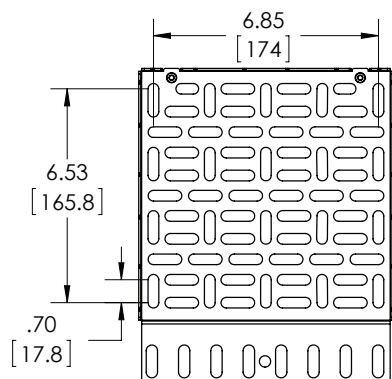

HOOK & LOOP STRAP

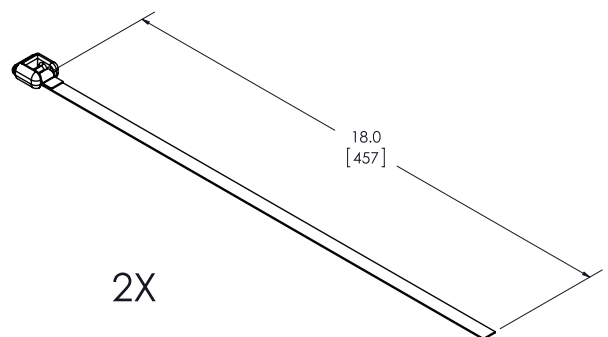

SANUS®

Specifications are subject to change.
Visit us at [legrandav.com](https://www.legrandav.com)

© 2019 Legrand AV Inc.

legrand® | AV

SANBLK0919